

Installation instructions for your new

CROSSTOP III Please read these

instructions carefully, whether you install this yourself or not.

NOTES:

- *In fact, we recommend an experienced bicycle mechanic install this product. We also recommend installing new cables and housing, with fresh lube.
- *This brake is suitable for front or rear use. It is very powerful and easy to modulate. Use it anywhere a side pull brake is advantageous.
- *Lube all pivot points with chain lube after every ride, including a drop between quick release link ball and long arm.
- *Periodically make sure all screws and nuts are tight.

Technical stuff:	CROSSTOP III	CROSSTOP III MC
Weight	125 grams	140 grams
Arms	6061 t-6	6061 t-6
Eye & Mount screws	6-6 titanium	303 stainless
DEALIE & Link	6061 t-6	6061 t-6
Dealie pivots	brass	brass

INSTALLATION:

(1) Remove pivot mount screw (#19) and disassemble pivot. Grease all parts and reassemble. Small o-ring goes in front, (fig A). Loosen brake shoe eyebolts (#13) and rotate shoes to parallel with rim. Screw mounting screws into frame studs. Make sure arrows on brake/shoes correspond to tire rotation.

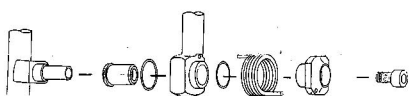

Fig A

(2) Place set up pin through DEALIE (#7 & 8) and into notch in arm (fig B). Place cross link in right arm, link may need to be unscrewed some. Rotate spring adjuster nuts (# 2D) outward 1/6 turn and tighten mount screws to 120in lbs (13.7 Nm)(fig C). Set brake pad shoes by loosening shoe eyebolt nut and moving the shoe into position. These shoes require very little toe in. Rotate each arm to make sure pads don't hit tire. Tighten nut to 55in lbs (6.2 Nm). Brake shoes should sit 2mm from rim.

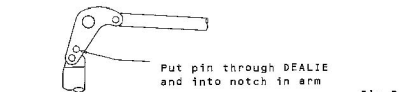

Fig B

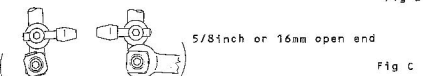

Fig C

(3) With set up pin still in DEALIE, thread cable into cable housing stop (# 3) in DEALIE. Housing from frame to DEALIE needs to form a nice flowing curve, with no sharp bends. Housing goes into large hole in housing stop. Thread cable into cable clamp, make sure all housing ends are seated, pull firmly on cable and tighten cable clamp screw. Your DEALIE is now set. All other adjustments should be made with the cross link and shoes.

(4) Remove DEALIE set up pin. Squeeze brake several times. Check for clearance between arms and tire in squeezed position (fig D). If more clearance is needed replace set up pin, unscrew cross link, and reset shoes with more of the pad stud extended towards rim.

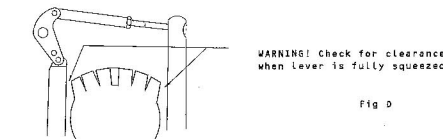

Fig D

(5) Remove set up pin (if needed) and squeeze brake. Adjust spring tension to personal preference by loosening mounting screws and turning the spring adjuster nuts. For adjusting where your lever ends up at full stop, adjust cross link. Unscrew lever barrel adjuster 1 or 2 turns to remove all slack from the cable if needed.

(6) Double check all screws and nuts, and test ride in the parking lot. This brake can overwhelm many seat stays. If you are getting a lot of flex, or an overly mushy feel, we recommend a brake arch, also known as a brake stiffener. We make a really boss one, known as the BRAKE BUDDY.

For use with Shimano V-BRAKE Levers:

When ever we design new parts we always make them so they work best with the other components we manufacture. These brakes therefore work the very best with our beautiful LOVE LEVERS, and we always recommend using this set up. However we do test them with other makes to check compatibility.

Because the v-brake lever causes the brake to activate so fast, it is best to screw in the reach adjust screw as far as possible. Also remove any plastic shims from the cable slot in the lever. This way the lever will be closer to the grip at full brake, which is much more comfortable. It also lets the lever go into its higher power range.

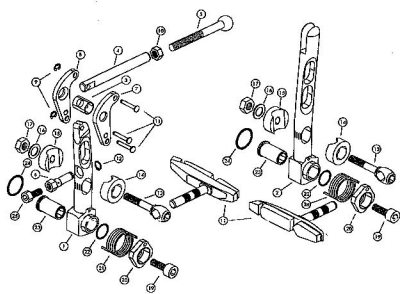

CROSSTOP III PARTS LIST

1	CT-01	Left Arm
2	CT-02	Right Arm
3	CT-03	Housing Stop
4	CT-04	Link, Female
5	CT-05	Link, Male
6	CT-06	Cable Clamp
7	CT-07	Dealie, Front
8	CT-08	Dealie, Rear
9	CT-09	Dealie Pin Clip
10	CT-10	Link Lock Nut
11	CT-11	Dealie Pins (3, 1 for set up only)
12	CT-12	Cable Clamp Clip
13	SL-09	Pad Eyebolt
14	SL-07	Pad Adjust Washer, Front
15	SL-06	Pad Adjust Washer, Rear
16	SL-10	Eyebolt Flat Washer
17	SL-11	Eyebolt Nut
18	CT-18	There is no 18
19	SL-16	Pivot Mount Screw
20	SL-05	Spring Adjustment Nut
21	SL-14	Return Spring, Left (Gold)
22	SL-12	O-Ring, Front (Small)
23	SL-03	Pivot
24	SL-13	O-Ring, Rear (Large)
25	SL-16	Cable Clamp Screw, Big Head
26	SL-15	Return Spring, Right (Silver)



po box 4826 chico california usa
e-mail: pce@pinsight.com
http://www.pauldirt.com

OUR WARRANTY:
Paul Component Engineering Inc. takes great pride in manufacturing high quality products out of the finest materials. All components are checked thoroughly at all steps of the manufacturing process for fit, finish, and material defects.
All products are warranted for a period of five years against defects in materials and workmanship only. This warranty applies only to the original purchaser of this product. Note: Ball bearings are not covered by this warranty.
In order to keep this warranty intact, and keep your components in good working order we recommend the following:
1. Inspect your components on a regular basis for cracks, bending, distorted adjusting, dents or any other distortions. Any components with such features should be replaced immediately.

2. Thoroughly read and follow product installation instructions when installing component.
3. Clean and lube the components where applicable as described in the installation instructions.
4. Never, ever modify a component. Any modification will void all warranties.
5. Warranty on all components is void if defect is due to damage from abuse, neglect, improper repair, improper fit, or any use unintended by the manufacturer.

We have at the plant sincerely want to provide you with years of trouble free riding. Please respect the 28RA off-road code. Do some trail maintenance too.
HAVE FUN & BE SAFE.